

# Plywood Pressing Line R5

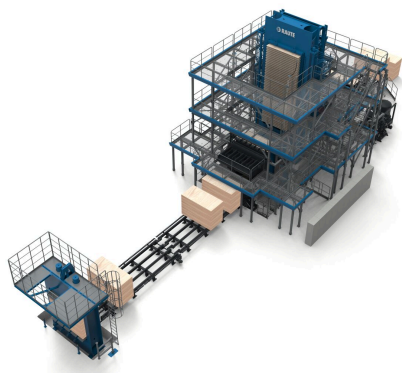

## BENEFITS

- The shortest press open time in the market increases capacity
- Up to 40 openings for large capacity
- Easy to use press user interface

## TECHNICAL DETAILS

Operators on the Line	1
Installed power (kW)	200
Available sizes (ft)	4x8, 5x10
Daylight No. (max)	40
Daylight opening (max)(mm)	80
Product Thickness Range (mm)	4 - 35
Press open-time (s)	< 90
Pre-press Opening Speed (mm/s)	30
Lay-up Feeding Rate (pcs/min)	10
Hot Press Temperature accuracy (+/- C)	5