

# Veneer Drying Line R5

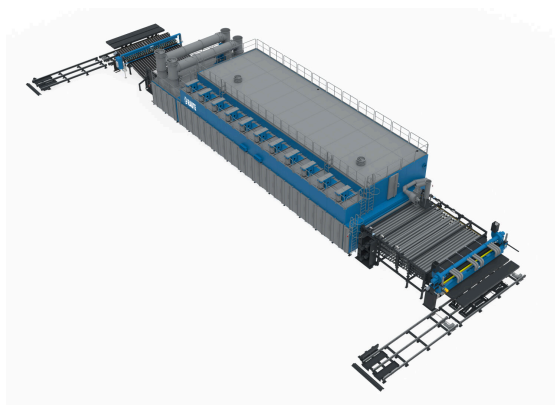

## BENEFITS

- 189 Raute R5-Series lines have been delivered
- The oldest still operating Raute drying line was installed in 1974
- There are 46 Raute 6200 mm, "4-wide" dryers making moisture optimized veneer globally
- 47 pcs of popular 6-deck dryer have been delivered by Raute

## TECHNICAL DETAILS

Veneer thickness (mm)	1,0 - 4
Operators on the Line	3
Heat Energy Consumption (KWh/m <sup>3</sup> Dry Veneer)	403
Stainless Steel Skins	No
Drying Time (min)*	3.09
Make-up Air Valves	●
Smoke extraction cells	●
Optimized heating system	●
Misting System	●
Dry veneer capacity* up to (m <sup>3</sup> /h)	12,3
Installed power (kW)	655